



Notice of Application Certification of Public Notice

CITY OF REDMOND

DEPARTMENT OF PLANNING AND COMMUNITY DEVELOPMENT

CERTIFICATE OF MAILING

I hereby certify that to the best of my knowledge a Notice of Application for LMC Marymoor File number: LAND-2018-00868 / 869 was sent to the Applicant and to the attached mailing list copy, by first class mail, on or before April 26, 2019.

Name: Gloria Meerscheidt

Date: April 26, 2019

CERTIFICATE OF POSTING

I, the undersigned, certify that on April 26, 2019, I posted copies of the attached Notice of Application at:

- 3 Location(s) on or near the site
- 1 City Hall
- 1 Library

Name: David Lee

Date: April 26, 2019

Name	Address	City	Sate Zip	Email
Natalya Tkach				tkach.natalya@gmail.com
David Morton	19934 NE Union Hill Rd	Redmond	WA 98053	davidwardmorton@yahoo.com
Reggie Mitchell				reggiem@rocketmail.com
Subhadra Terhanian				subi@uncleharrys.com
Kristin Ramey				kristinR@kpff.com
				andy@wdginc.com
Andy Rasmussen	2329 East Madison St	Seattle	WA 98112	(andy@waginc.com ?)
Jennifer Filipovieh	9518 168th Ave NE	Redmond	WA 98052	jmfilipovich@hotmail.com
Tom Schmidlin				tom@postdocbrewing.com
Alana McWade				alanamcwade@umpquabank.com

3MD INC 17735 NE 65TH ST Redmond, WA 98052	3Sharp LLC 18300 REDMOND WAY 130 Redmond, WA 98052	654WASHINGTON HYDRAULICS, INC. 17611 NE 70TH ST Redmond, WA 98052
A PLUS FIRE & SAFETY 18760 NE 59TH CT Redmond, WA 98052	A.A.R. TESTING LABORATORY, INC 7126 180TH AVE NE Redmond, WA 98052	Aable Safety Clean, Inc 18844 NE 84TH ST Redmond, WA 98052
Abossein Engineering, LLC 18465 NE 68TH ST Redmond, WA 98052	ACME AUTO DETAIL 17825 NE 65TH ST BLDG A 165 Redmond, WA 98052	ACRYLIC CONCEPTS, INC. 17932 NE 65TH ST Redmond, WA 98052
ADURO, Inc 17425 UNION HILL RD 100 Redmond, WA 98052	AIPHONE CORPORATION 6670 185TH AVE NE Redmond, WA 98052	AIRCRAFT CABIN SYSTEMS 18080 NE 68TH ST BLDG B Redmond, WA 98052
ALASKA TRAVEL ADVENTURES INC. 18384 REDMOND FALL CITY HWY Redmond, WA 98052	ALL CLIMATE HEATING & AIR 17527 NE 67TH CT Redmond, WA 98052	All Goes Smoothie LLC 7956 178TH PL NE Redmond, WA 98052
ALL THE BEST PET CARE 17875 REDMOND WAY Redmond, WA 98052	ALL WOOD RECYCLING, INC 8504 192ND AVE NE Redmond, WA 98052	ALLIED ROOFING, INC. 17371 NE 67TH CT BLDG A 10 Redmond, WA 98052
Allure Services LLC 6546 195TH PL NE Redmond, WA 98052	APPLUS+ TECHNOLOGIES, INC 18610 NE 67TH CT Redmond, WA 98052	Arabisk Cafe 17550 NE 67TH CT Redmond, WA 98052
ART SCHOOL ELLEN LLC 18005 NE 68TH ST Redmond, WA 98052	ASIANA BISTRO 17875 REDMOND WAY Redmond, WA 98052	ASSOCIATED PETROLEUM PRODUCTS 7822 178TH PL NE Redmond, WA 98052
Authentic Motorcars NW, LLC. 17351 NE 70TH ST Redmond, WA 98052	AUTOSYS INC 18018 REDMOND WAY Redmond, WA 98052	BASIS SOFTWARE INC 18103 NE 68TH ST Redmond, WA 98052
BBK CONSULTING INC 17351 NE 70TH ST Redmond, WA 98052	BELLE III LLC 17725 NE 65TH ST BLDG B 210 Redmond, WA 98052	BICYCLE ADVENTURES INC 18047 NE 68TH ST Redmond, WA 98052

BIONA US LLC 17611 NE 70TH ST Redmond, WA 98052	BIO-RAD LABORATORIES 6565 185TH AVE NE Redmond, WA 98052	BIRDWELL MACHINE LLC 17445 NE 70TH ST Redmond, WA 98052
BLACKSTONE OTR LLC 6820 176TH AVE NE Redmond, WA 98052	BLAZING BAGELS 6975 176TH AVE NE Redmond, WA 98052	BOLLES CONSTRUCTION, INC. 18844 NE 84TH ST Redmond, WA 98052
BOMAR PROPERTIES, LLC 17520 NE 70TH ST Redmond, WA 98052	BOMBAY BITEZ LLC 18348 REDMOND FALL CITY HWY Redmond, WA 98052	BOUTIQUE AL-FIRDAWS 17550 NE 67TH CT Redmond, WA 98052
BRAVURA SOFTWARE LLC 6763 191ST PL NE Redmond, WA 98052	BREWHOUSE PROVISIONS 17725 NE 65TH ST BLDG B 250 Redmond, WA 98052	BRIDGESTONE RETAIL OPERATIONS LLC 18014 REDMOND WAY Redmond, WA 98052
BROWN BEAR CAR WASH 17809 REDMOND WAY Redmond, WA 98052	BUDSTER & CO LLC 17371 NE 67TH CT BLDG A 8 Redmond, WA 98052	Building Resources Inc 18386 REDMOND FALL CITY HWY Redmond, WA 98052
Bullseye Express One, LLC 7735 178TH PL NE 130 Redmond, WA 98052	C C C 2911 L.L.C. 18014 REDMOND WAY Redmond, WA 98052	CADMAN INC 18816 UNION HILL RD Redmond, WA 98052
CADMAN, INC. 7554 185TH AVE NE Redmond, WA 98052	CAFFE LUSO COFFEE ROASTERS 17725 NE 65TH ST BLDG A 150 Redmond, WA 98052	CALIBRATE PROPERTY MANAGEMENT 17634 UNION HILL RD 130 Redmond, WA 98052
CANTARE CHOCOLATE COMPANY LLC 18005 NE 68TH ST Redmond, WA 98052	CASCADE ENGINEERING SERVICES INC 6640 185TH AVE NE Redmond, WA 98052	CASCADE UTILITIES 7554 185TH AVE NE Redmond, WA 98052
CAVALIERE CONSTRUCTION CO LLC 7140 180TH AVE NE Redmond, WA 98052	CEDAR LAWNS MEMORIAL PARK #0209 7200 180TH AVE NE Redmond, WA 98052	CENTRAL WELDING SUPPLY 7730 185TH AVE NE Redmond, WA 98052
CHECK OUT MY LLC 6727 185TH AVE NE Redmond, WA 98052	CHESS4LIFE 7102 180TH AVE NE Redmond, WA 98052	CHIPOTLE MEXICAN GRILL 740 17875 REDMOND WAY Redmond, WA 98052

CLASS ACT 6855 176TH AVE NE Redmond, WA 98052	CLASSIC CLEANERS 6536 E LK SAMMAMISH PKWY Redmond, WA 98052	CLASSIC PHOTO BOOTH COMPANY 17725 NE 65TH ST BLDG B 235 Redmond, WA 98052
CMH Partners LLC 17875 REDMOND WAY 140 Redmond, WA 98052	COAST MEDICAL NORTHWEST, INC. 7114 180TH AVE NE Redmond, WA 98052	COMMIT CS LLC 6727 185TH AVE NE Redmond, WA 98052
COMPACT INFORMATION SYSTEMS 7120 185TH AVE NE Redmond, WA 98052	Compusave Inc 17735 NE 65TH ST 120 Redmond, WA 98052	COMPUTER TECHNICAL SERVICES INC 17725 NE 65TH ST BLDG B 240 Redmond, WA 98052
CONCORDIA COFFEE COMPANY INC 6812 185TH AVE NE Redmond, WA 98052	Cortexa LLC 17371 NE 67TH CT BLDG B 210 Redmond, WA 98052	COSTCO WHOLESALE CORP 7605 188TH AVE NE Redmond, WA 98052
COSTCO WHOLESALE CORPORATION 7725 188TH AVE NE Redmond, WA 98052	CREATIVE LABEL INC 18005 NE 68TH ST Redmond, WA 98052	CRM GROUP LLC 7120 185TH AVE NE Redmond, WA 98052
CURVET COMPANY 18080 NE 68TH ST BLDG C 120 Redmond, WA 98052	Darshana Shah 18666 REDMOND WAY BLDG DD 1027 Redmond, WA 98052	DATA I/O CORPORATION 6645 185TH AVE NE Redmond, WA 98052
DAVID INDUSTRIES INC 17965 NE 65TH ST Redmond, WA 98052	DEREMA GROUP INC 17371 NE 67TH CT BLDG A 9 Redmond, WA 98052	DISCOUNT TIRE CO OF WASHINGTON 17977 NE 76TH ST Redmond, WA 98052
DRESSER-RAND COMPANY 17825 NE 65TH ST BLDG A 155 Redmond, WA 98052	DRIVE SHOP LLC 18300 REDMOND WAY Redmond, WA 98052	DUNKIN & BUSH PAINTING, INC. 17301 NE 70TH ST Redmond, WA 98052
DUPAR, LISA CATERING 18005 NE 68TH ST Redmond, WA 98052	DYNACARE NORTHWEST INC 18100 UNION HILL RD Redmond, WA 98052	EASTSIDE AUTO CARE INC 17525 NE 67TH CT Redmond, WA 98052
EATON ARROWSMITH ACADEMY LTD 17946 NE 65TH ST Redmond, WA 98052	EDIFICE CONSTRUCTION CO INC 17445 NE 70TH ST Redmond, WA 98052	Edifice GC, Inc. 17445 NE 70TH ST 180 Redmond, WA 98052

ELA ENTERPRISES LLC 7956 178TH PL NE Redmond, WA 98052	ELECTRONIC CIGARETTES LLC 18001 NE 76TH ST Redmond, WA 98052	EMERALD CITY GYMNASTICS ACADEMY 17735 NE 65TH ST Redmond, WA 98052
ENDOGASTRIC SOLUTIONS 18109 NE 76TH ST Redmond, WA 98052	ENNCO DISPLAY SYSTEMS, INC. 6975 176TH AVE NE Redmond, WA 98052	ENTWINED CREATIVE LLC 6250 188TH LN NE Redmond, WA 98052
EOSPACE INC. 6222 185TH AVE NE Redmond, WA 98052	EPOCH DESIGN LLC 17617 NE 65TH ST Redmond, WA 98052	ESSEX REDMOND HILL CW LP 6110 186TH PL NE Redmond, WA 98052
ESSEX REDMOND HILL NE LP 18666 REDMOND WAY Redmond, WA 98052	Eurest Dining Services 6645 185TH AVE NE 150 Redmond, WA 98052	EVANS CREEK LLC 6205 188TH LN NE Redmond, WA 98052
EVERGREEN RESTAURANT GROUP LLC 7554 185TH AVE NE Redmond, WA 98052	FALLAH MICROANALYTICAL LABORATORY LLC 18372 REDMOND FALL CITY HWY Redmond, WA 98052	FAMILY PANCAKE HOUSE, LLC 17621 REDMOND WAY Redmond, WA 98052
FASTENAL COMPANY 17455 NE 67TH CT Redmond, WA 98052	FEDEX GROUND PACKAGE SYSTEM INC 18795 NE 73RD ST Redmond, WA 98052	FENCE SYSTEMS NW, INC. 7760 185TH AVE NE Redmond, WA 98052
FERGUSON ENTERPRISES INC 17515 NE 67TH CT Redmond, WA 98052	FIRECOVER EDC LLC 7126 180TH AVE NE Redmond, WA 98052	FIRSTFRUITS FEED 6848 180TH AVE NE Redmond, WA 98052
FITNESS NORTHWEST 7956 178TH PL NE Redmond, WA 98052	FORCE 10 PERFORMANCE LLC 17935 NE 65TH ST Redmond, WA 98052	FOUNTAINHEAD MOBILE SOLUTIONS 18047 NE 68TH ST Redmond, WA 98052
FRED MEYER JEWELERS #664 17667 NE 76TH ST Redmond, WA 98052	FRED MEYER STORES, INC. 17667 NE 76TH ST Redmond, WA 98052	FUKUDA DENSHI USA, INC. 17725 NE 65TH ST BLDG C Redmond, WA 98052
Functional Wellness Centers PLLC 17875 REDMOND WAY 160 Redmond, WA 98052	GeoEngineers, Inc. 17425 UNION HILL RD 250 Redmond, WA 98052	GIGGLES AND GRINS 17720 NE 65TH ST Redmond, WA 98052

GLADE COMMUNICATION EQUIPMENT 17371 NE 67TH CT BLDG B 1 Redmond, WA 98052	GOLDER ASSOCIATES INC 18300 UNION HILL RD Redmond, WA 98052	Golder Associates Inc. 18366 REDMOND-FALL CITY RD Redmond, WA 98052
GOLFCO INTERNATIONAL INC 18009 NE 76TH ST Redmond, WA 98052	Google LLC 17275 NE 67TH CT Redmond, WA 98052	GOTTA DANCE 17945 NE 65TH ST Redmond, WA 98052
GREEN SPACES LANDSCAPING LLC 7822 178TH PL NE Redmond, WA 98052	GREENROADS FOUNDATION 17371 NE 67TH CT BLDG B 202 Redmond, WA 98052	GREGORY DRILLING, INC. 17609 NE 70TH ST Redmond, WA 98052
GUCKENHEIMER SERVICES LLC @GENIE 18700 NE 65TH ST Redmond, WA 98052	GUCKENHEIMER SERVICES LLC @GENIE 6464 185TH AVE NE Redmond, WA 98052	Guys In White Software 6300 187TH PL NE 303 Redmond, WA 98052
HARMONY MUSIC 17725 NE 65TH ST BLDG B 235 Redmond, WA 98052	HICKSGAS LLC 18459 NE 76TH ST Redmond, WA 98052	HILLTOP ENTERPRISES INC 18001 NE 76TH ST 105 Redmond, WA 98052
HOME DEPOT USA, INC 17777 NE 76TH ST Redmond, WA 98052	HWANG'S AFTER SCHOOL PROGRAM 18133 NE 68TH ST Redmond, WA 98052	HWANG'S TAEKWONDO SCHOOL INC 18210 REDMOND WAY Redmond, WA 98052
I C POKE INC 17875 REDMOND WAY 144 Redmond, WA 98052	I D D AEROSPACE CORP. 18225 NE 76TH ST Redmond, WA 98052	IBSEN TOWING 17725 NE 65TH ST BLDG A 120 Redmond, WA 98052
IBSEN TOWING 17611 NE 70TH ST Redmond, WA 98052	JAACO CORPORATION 18080 NE 68TH ST BLDG C 130 Redmond, WA 98052	JACOBSON MACHINERY LLC 17445 NE 70TH ST Redmond, WA 98052
JAWHARA CAFA LLC 17550 NE 67TH CT Redmond, WA 98052	JOINT VENTURES LLC 17875 REDMOND WAY Redmond, WA 98052	JONES, EDWARD D & COMPANY 17887 REDMOND WAY 125 Redmond, WA 98052
JPMORGAN CHASE BANK N A 17667 NE 76TH ST Redmond, WA 98052	Kaiser Health Solutions PS 17523 NE 67TH CT Redmond, WA 98052	KASSEL & ASSOCIATES INC 7126 180TH AVE NE Redmond, WA 98052

KDLM LLC 18047 NE 68TH ST Redmond, WA 98052	KELLER SUPPLY CO, REDMOND 18315 NE 76TH ST Redmond, WA 98052	KEN'S TOWING INC. 7730 185TH AVE NE Redmond, WA 98052
Keystone Infrastructure Consulting 6455 193RD PL NE Redmond, WA 98052	KINDERCARE LEARNING CENTERS LLC 6534 E LK SAMMAMISH PKWY Redmond, WA 98052	KOHL'S #1136 17601 UNION HILL RD Redmond, WA 98052
LA GAUCHADA LLC 18348 REDMOND FALL CITY HWY Redmond, WA 98052	LABEL MASTERS INC. 17965 NE 65TH ST Redmond, WA 98052	LAKESIDE INDUSTRIES, INC 18816 UNION HILL RD Redmond, WA 98052
LeFevre Shelley Ltd 6225 189TH PL NE 103 Redmond, WA 98052	LES SCHWAB TIRE CENTER #394 6651 E LK SAMMAMISH PKWY Redmond, WA 98052	LINDER ELECTRIC 7004 180TH AVE NE Redmond, WA 98052
LN Bear Creek LLC 17425 UNION HILL RD Redmond, WA 98052	Lux Design Builds 18388 REDMOND-FALL CITY RD Redmond, WA 98052	LUXOTTICA RETAIL NORTH AMERICA 17700 NE 76TH ST Redmond, WA 98052
M & M SUPPLY CO LLC 18844 NE 84TH ST Redmond, WA 98052	Marc Singer Agency LLC 17634 UNION HILL RD 110 Redmond, WA 98052	MARYMOOR CAR AND BOAT STORAGE 17351 NE 70TH ST Redmond, WA 98052
MARYMOOR FURNITURE 17725 NE 65TH ST BLDG A 115 Redmond, WA 98052	MAVERICK SPORTS MEDICINE, INC 18080 NE 68TH ST BLDG A 150 Redmond, WA 98052	Menyoo, LLC 18548 NE 57TH ST Redmond, WA 98052
MERCURYS COFFEE CO. 17980 REDMOND WAY Redmond, WA 98052	MERCURYS MADNESS INC 17634 UNION HILL RD Redmond, WA 98052	MERITAGE SOUPS LLC 18211 NE 68TH ST Redmond, WA 98052
Metropolitan Detail Inc. 7410 185TH AVE NE Redmond, WA 98052	MI BAO BAO LLC 6456 192ND PL NE Redmond, WA 98052	MICROSOFT CORPORATION 17760 NE 67TH CT Redmond, WA 98052
MICROSOFT CORPORATION 18200 UNION HILL RD Redmond, WA 98052	MICROSOFT CORPORATION 18300 UNION HILL RD Redmond, WA 98052	MICROSOFT CORPORATION 18400 UNION HILL RD Redmond, WA 98052

MICROSOFT CORPORATION
18500 UNION HILL RD
Redmond, WA 98052

MICROVISION, INC
6244 185TH AVE NE
Redmond, WA 98052

MUSLIM ASSOC OF PUGET SOUND
17550 NE 67TH CT
Redmond, WA 98052

NCM Direct Delivery
7735 178TH PL NE 120
Redmond, WA 98052

Northwest Fighting Academy
17519 NE 67TH CT
Redmond, WA 98052

Okeanus Science & Technology, LLC
17455 NE 67TH CT 120
Redmond, WA 98052

Pacific Bioscience Laboratories, Inc
17425 UNION HILL RD 150
Redmond, WA 98052

PEET'S OPERATING CO. INC
17887 REDMOND WAY
Redmond, WA 98052

Perfect Pair Catering, LLC
6855 176TH AVE NE 200
Redmond, WA 98052

PLANETARY RESOURCES INC.
6742 185TH AVE NE
Redmond, WA 98052

MICROSOFT CORPORATION
18600 UNION HILL RD
Redmond, WA 98052

MLS TECHNOLOGIES INC
6855 176TH AVE NE
Redmond, WA 98052

MV PUBLIC TRANSPORTATION INC
18690 NE 73RD ST
Redmond, WA 98052

NEWPORT CUSTOM SHUTTERS
6975 176TH AVE NE
Redmond, WA 98052

NORTHWEST PAPER SUPPLIES
17371 NE 67TH CT BLDG B 6
Redmond, WA 98052

O'NEILL ENVIRONMENTAL SERVICES
17619 NE 67TH CT
Redmond, WA 98052

PAIZO INC
7120 185TH AVE NE
Redmond, WA 98052

PENDANO ELITE FITNESS & ATHLETICS
17625 NE 65TH ST
Redmond, WA 98052

PERFORMANCE MODALITIES INC
18100 UNION HILL RD
Redmond, WA 98052

POSTDOC BEVERAGES LLC
17625 NE 65TH ST
Redmond, WA 98052

MICROSOFT CORPORATION
18700 UNION HILL RD
Redmond, WA 98052

MMCS LLC
18103 NE 68TH ST
Redmond, WA 98052

MY-WAY CONSTRUCTION LLC
6855 176TH AVE NE
Redmond, WA 98052

NORTH SOUND MASSAGE THERAPY LLC
7956 178TH PL NE
Redmond, WA 98052

NOW IMPRESSIONS, INC.
17965 NE 65TH ST
Redmond, WA 98052

Organized Play Foundation
7120 185TH AVE NE 120
Redmond, WA 98052

PAN PACIFIC ELECTRONICS, INC.
17985 NE 65TH ST
Redmond, WA 98052

PENSKE TRUCK LEASING CO LP
17285 NE 70TH ST
Redmond, WA 98052

PERMA-CHINK SYSTEMS INC
17635 NE 67TH CT
Redmond, WA 98052

POTELCO, INC.
18150 REDMOND WAY
Redmond, WA 98052

PRACTEC L.L.C. 17625 NE 65TH ST Redmond, WA 98052	PREPARESMART LLC 17725 NE 65TH ST BLDG B 200 Redmond, WA 98052	PRIDE ELECTRIC 18133 NE 68TH ST Redmond, WA 98052
Priority One Communications 18620 NE 62ND WAY 105 Redmond, WA 98052	PROTO DESIGN, INC. 17824 NE 65TH ST Redmond, WA 98052	PT VENTURES LLC 17455 NE 67TH CT Redmond, WA 98052
QUALITY TOWING INC 17611 NE 70TH ST Redmond, WA 98052	R P M SYSTEMS CORP. 17371 NE 67TH CT BLDG A 5 Redmond, WA 98052	Radiant Vision Systems, LLC 18640 NE 67TH CT Redmond, WA 98052
RAINIER WELDING, INC. 19020 NE 84TH ST Redmond, WA 98052	REDBOX AUTOMATED RETAIL LLC 17667 NE 76TH ST Redmond, WA 98052	RED-E TRUCKING, INC. 18816 UNION HILL RD Redmond, WA 98052
REDMOND ACADEMY OF THEATRE ARTS 18001 NE 76TH ST Redmond, WA 98052	REDMOND EUROPEAN 18080 NE 68TH ST BLDG E Redmond, WA 98052	Redmond Hotel Holdings LLC 7045 180TH AVE NE Redmond, WA 98052
REDMOND KIDS 5931 189TH PL NE Redmond, WA 98052	Redmond Pancake House LLC 17621 REDMOND WAY Redmond, WA 98052	Redmond Ridge Spirits LLC 18001 NE 76TH ST Redmond, WA 98052
REDMOND SELF STORAGE 17285 NE 70TH ST Redmond, WA 98052	REDMOND TIRE FACTORY 17657 REDMOND WAY Redmond, WA 98052	REDMOND TODDLER GROUP 17725 NE 65TH ST BLDG A 100 Redmond, WA 98052
Redmond Vision Clinic 17634 UNION HILL RD 120 Redmond, WA 98052	Revelare International, LLC 18548 NE 57TH ST Redmond, WA 98052	RODDA PAINT COMPANY 17836 NE 65TH ST Redmond, WA 98052
ROLLING FRITO-LAY SALES, LP 17250 NE 67TH CT Redmond, WA 98052	ROSE POINT NAVIGATION SYSTEMS 18005 NE 68TH ST Redmond, WA 98052	Royal Hospitality Washinton LLC 17770 NE 78TH PL Redmond, WA 98052
RSRC BEAR CREEK LLC 17634 UNION HILL RD Redmond, WA 98052	S & P DESIGNS 17371 NE 67TH CT BLDG B 2 Redmond, WA 98052	S.R. COMPANY INC 17725 NE 65TH ST BLDG A 135 Redmond, WA 98052

Saai Naatha LLC 6536 EAST LK SAMMAMISH PKWY NE 107 Redmond, WA 98052	SAHALEE LIQUOR COMPANY INC 18009 NE 76TH ST Redmond, WA 98052	SAMMAMISH CLEANERS 17875 REDMOND WAY Redmond, WA 98052
SAMMAMISH HOT YOGA 18047 NE 68TH ST Redmond, WA 98052	SAMMAMISH MONTESSORI SCHOOL 7655 178TH PL NE Redmond, WA 98052	SANDWICH SC LLC 17875 REDMOND WAY Redmond, WA 98052
SAPPORO TERIYAKI 18600 UNION HILL RD Redmond, WA 98052	Sapporo Teriyaki 18600 UNION HILL RD Redmond, WA 98052	SASQUATCH CROSSFIT 2016 LLC 17523 NE 67TH CT Redmond, WA 98052
SCHAWK USA 18211 NE 68TH ST Redmond, WA 98052	Searose LLC 6825 176TH AVE NE 110 Redmond, WA 98052	SERVICE KING PAINT & BODY LLC 18138 REDMOND WAY Redmond, WA 98052
SHAMROCK SECURITY SYSTEMS INCQ 17725 NE 65TH ST BLDG A 160 Redmond, WA 98052	SHERWIN-WILLIAMS COMPANY 18014 REDMOND WAY Redmond, WA 98052	SIGN ASSOCIATES, INC. 6825 176TH AVE NE Redmond, WA 98052
SIGN PROS 17425 NE 70TH ST Redmond, WA 98052	Silicom Trade USA Co Ltd 17371 NE 67TH CT B208 Redmond, WA 98052	SITTIG, INC 18895 NE 68TH ST Redmond, WA 98052
SKANSKA USA BUILDING INC 19114 NE 84TH ST Redmond, WA 98052	SKINSPIRIT ESSENTIAL LLC 17887 REDMOND WAY Redmond, WA 98052	SOFTWARE MUNITIONS 18607 NE 57TH ST Redmond, WA 98052
SPACE EXPLORATION TECHNOLOGIES 18390 NE 68TH ST Redmond, WA 98052	SPIRATION, INC. 6675 185TH AVE NE Redmond, WA 98052	SR BUILDING SERVICES LLC 7710 185TH AVE NE Redmond, WA 98052
S. VEDIC EDUCATION & TRN ACADEMY 18109 NE 76TH ST Redmond, WA 98052	STONE MOUNTAIN SCREEN PRINTING 17725 NE 65TH ST BLDG A 130 Redmond, WA 98052	STUC-O-FLEX INTERNATIONAL, INC 17639 NE 67TH CT Redmond, WA 98052
SUNBELT RENTALS INC 17950 REDMOND WAY Redmond, WA 98052	SUNBELT RENTALS INC 18455 NE 76TH ST Redmond, WA 98052	SWAGATH HOME FOODS LLC 18001 NE 76TH ST Redmond, WA 98052

SWEET & TASTY LLC 18636 NE 55TH WAY Redmond, WA 98052	TARGET STORES #995 17700 NE 76TH ST Redmond, WA 98052	TCM Workplace Wellness 18631 NE 59TH CT 205 Redmond, WA 98052
TEDDY BEAR CREEK LEARNING CENTER 17950 UNION HILL RD Redmond, WA 98052	TEREX USA LLC 18460 NE 76TH ST Redmond, WA 98052	TEREX WASHINGTON 18460 NE 76TH ST Redmond, WA 98052
TERRADALE GLASS LLC 7102 180TH AVE NE Redmond, WA 98052	TEXAS INSTRUMENTS 6244 185TH AVE NE Redmond, WA 98052	The Bond Apartments, LLC 6180 EAST LK SAMMAMISH PKWY Redmond, WA 98052
THE RETIREMENT SOLUTION INC 18300 REDMOND WAY Redmond, WA 98052	The Workshop Academy 18344 REDMOND-FALL CITY RD Redmond, WA 98052	THERRIAULT-COGAN LLC 18620 NE 67TH CT Redmond, WA 98052
THERRIAULT-FLECK 6727 185TH AVE NE Redmond, WA 98052	THREE LITTLE BEARS, THE LLC 17935 NE 65TH ST Redmond, WA 98052	TI ACQUISITION CO., LLC 17640 NE 65TH ST Redmond, WA 98052
TIME SAVING SERVICES, INC 17371 NE 67TH CT BLDG A 4 Redmond, WA 98052	TINGE BLENDS LLC 19114 NE 64TH WAY Redmond, WA 98052	TRAN, UYEN O.D. 17700 NE 76TH ST Redmond, WA 98052
TRIMSEAL USA, INC. 17371 NE 67TH CT BLDG A 2 Redmond, WA 98052	Ultimate Baker 7114 180TH AVE NE 106 Redmond, WA 98052	ULTRA ELECTRONICS 6724 185TH AVE NE Redmond, WA 98052
UMPQUA BANK 17875 REDMOND WAY Redmond, WA 98052	UNCLE HARRY'S NATURAL PRODUCTS 17650 NE 65TH ST Redmond, WA 98052	UNITED PARCEL SERVICE 18001 UNION HILL RD Redmond, WA 98052
UNIVAR USA INC 17411 UNION HILL RD Redmond, WA 98052	USCUTTER INC 17945 NE 65TH ST Redmond, WA 98052	User Research International 17602 UNION HILL RD Redmond, WA 98052
VCA ANIMAL HOSPITALS, INC 17980 UNION HILL RD Redmond, WA 98052	Veggie Paradise LLC 6855 176TH AVE NE 225 Redmond, WA 98052	VEHICLE MONITOR CORPORATION 6825 176TH AVE NE Redmond, WA 98052

VERITOX, INC.
18372 REDMOND FALL CITY HWY
Redmond, WA 98052

Vidhi Modi
18655 NE 63RD WAY 101
Redmond, WA 98052

VISION WAREHOUSE, LLC
6975 176TH AVE NE
Redmond, WA 98052

VITAMIN SHOPPE INDUSTRIES INC
17980 REDMOND WAY
Redmond, WA 98052

WASHINGTON WINDOW AND DOOR
17832 NE 65TH ST
Redmond, WA 98052

WATSON ASPHALT PAVING CO INC
19220 UNION HILL RD
Redmond, WA 98052

WEDDING & EVENT CATERING LLC
18001 NE 76TH ST
Redmond, WA 98052

Weldon Barber
17887 REDMOND WAY 110
Redmond, WA 98052

WESTERN FLOORING & HARDWOOD
17455 NE 67TH CT
Redmond, WA 98052

WESTERN TILE & MARBLE
7140 180TH AVE NE
Redmond, WA 98052

White Canvas Arts
18666 REDMOND WAY BLDG RR 1136
Redmond, WA 98052

WHITE COAT MARKETING LLC
7730 185TH AVE NE
Redmond, WA 98052

WHOLE FOODS MARKET
17991 REDMOND WAY
Redmond, WA 98052

WILD TANGENT, INC.
18578 NE 67TH CT
Redmond, WA 98052

WINDSOR PROPERTY MANAGEMENT
6332 E LK SAMMAMISH PKWY
Redmond, WA 98052

Wireless Advocates LLC
7725 188TH AVE NE
Redmond, WA 98052

Xidias, Inc
18028 REDMOND WAY 31D
Redmond, WA 98052

YARDMASTER INC
6926 176TH AVE NE
Redmond, WA 98052

ZENROCK FITNESS
18047 NE 68TH ST
Redmond, WA 98052

ZEVO KIDS LLC
19227 NE 64TH WAY
Redmond, WA 98052



Date: April 26, 2019

SUBJECT: LMC Marymoor

Dear City of Redmond Property Owner:

The City of Redmond has received an application to develop land that is within 500' of your property. Since the proposal is close to your property and the proposal might affect you, your property, or your neighborhood, the City is sending you this letter and the enclosed materials for you to review. With this letter, you will find the following:

1. A vicinity map showing the proposal's location.
2. A public notice describing the proposal, and the methods and deadlines for you to provide comments to City staff.
3. A preliminary site layout illustrating the proposal's design.
4. A process flow chart illustrating where, when, and how you can submit comments.
5. A preliminary tree preservation plan (only if tree removal is proposed).

The City invites you to comment on this proposal. You may submit your written comments to the City (see the enclosed public notice for contact information). Comments may be mailed, e-mailed, or faxed. If you wish to be informed of future actions or would like to become a party of record on this proposal you must provide your name and mailing address to the project planner.

You should feel free to share this with neighbors. Some neighbors may not have received this packet. People not receiving notices are often those neighbors who recently purchased their property or whose property is over 500' from the proposal. Although not officially notified, these neighbors may provide comments also. To receive future notices, they may also request to be a "party of record". To become a party of record an interested person should call, write, or e-mail the contact person, and request to be a party of record.

The City of Redmond looks forward to receiving your comments or answering your questions. Finally, on behalf of the City, I thank you for your interest and participation in your community, the City of Redmond.

Sincerely,

Erika Vandenbrande
Director of Planning and Community Development



City of Redmond Notice of Application

For more information about this project visit www.redmond.gov/landuseapps

Project Information

Application Type: Consolidated Review
LAND-2018-00868, Master Planned Development
LAND-2018-00869, Development Agreement

Project Name: LMC Marymoor

Project Description: Project is located 17611 NE 70th Street on 213,501 sf (4.89 acres). Demolition of existing commercial buildings & parking lots. Construction of (1) six story and (2) five story +/- 307,980 sf multi-family

Project Location: 17609 NE 70TH ST

Site Address, If Applicable: 6900 176TH AVE NE

Size of Subject Area in Acres: 4.88 Sq.Ft. 0

Applicant: Rocky Flores

Process Type: V (see attached flow chart)

A Public Hearing is required, however a date has yet to be determined. A Public Hearing notice will be sent in the future.

Required Permits, not a part of this application:

Administrative Modification, Boundary Line Adjustment, Building Permits, Fire Permits, Master Planned Development, Public Works Permits, Site Plan Entitlement

Required Studies:

Critical Aquifer Recharge Area Report, Geologic Hazard Report, Parking Analysis, Stormwater Report, Traffic Study, Tree Health Assessment

Existing Environmental Documents, relevant to this application:

SEPA Checklist

Important Dates

Application & Completeness Date: April 26, 2019

Notice of Application Date: April 26, 2019

To allow a minimum comment period as specified in RZC, the City will not issue a decision on this project prior to May 17, 2019. If date ends on a weekend or holiday comments are due on the next business day.

Regulatory Information

Zoning: MDD2

Comprehensive Plan Designation: Design District

Consistent with Comprehensive Plan: Yes

Applicable Development Regulations: Redmond Municipal Code & Zoning Code

Public Comment

Although comments are accepted up until close of public hearing, submittal of comments during the comment period required in the RZC will ensure comments are considered prior to issuing a decision and will allow staff and/or the applicant to address comments as early in the process as possible. The Technical Committee shall not issue a recommendation until the end of the minimum comment period. In addition, persons who want to be informed of future actions or would like to become a party of record on this proposal must provide their name and mailing address to the project planner. Submit written comments or name and address to be added as a party of record to the City of Redmond Planning Department, Development Services Center 15670 NE 85th Street, P.O. Box 97010, Mail Stop 2SF Redmond, WA 98073-9710, or fax to 425-556-2401. The final decision on this proposal may be appealed according to the City appeal provision specified in RZC Chapter 21.76, Review Procedures.

City Contact Information

Project Planner Name: David Lee

Phone Number: 425-556-2462

Email: dlee@redmond.gov

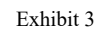
This image shows a blank sheet of white paper with horizontal ruling lines. The lines are evenly spaced and run across the width of the page. There is no handwriting or other markings on the paper.

Vicinity Map

LAND-2018-00868, Master Planned Development
LAND-2018-00869, Development Agreement

Parcel Number(s): 1225059229, 1225059152, and 1225059095

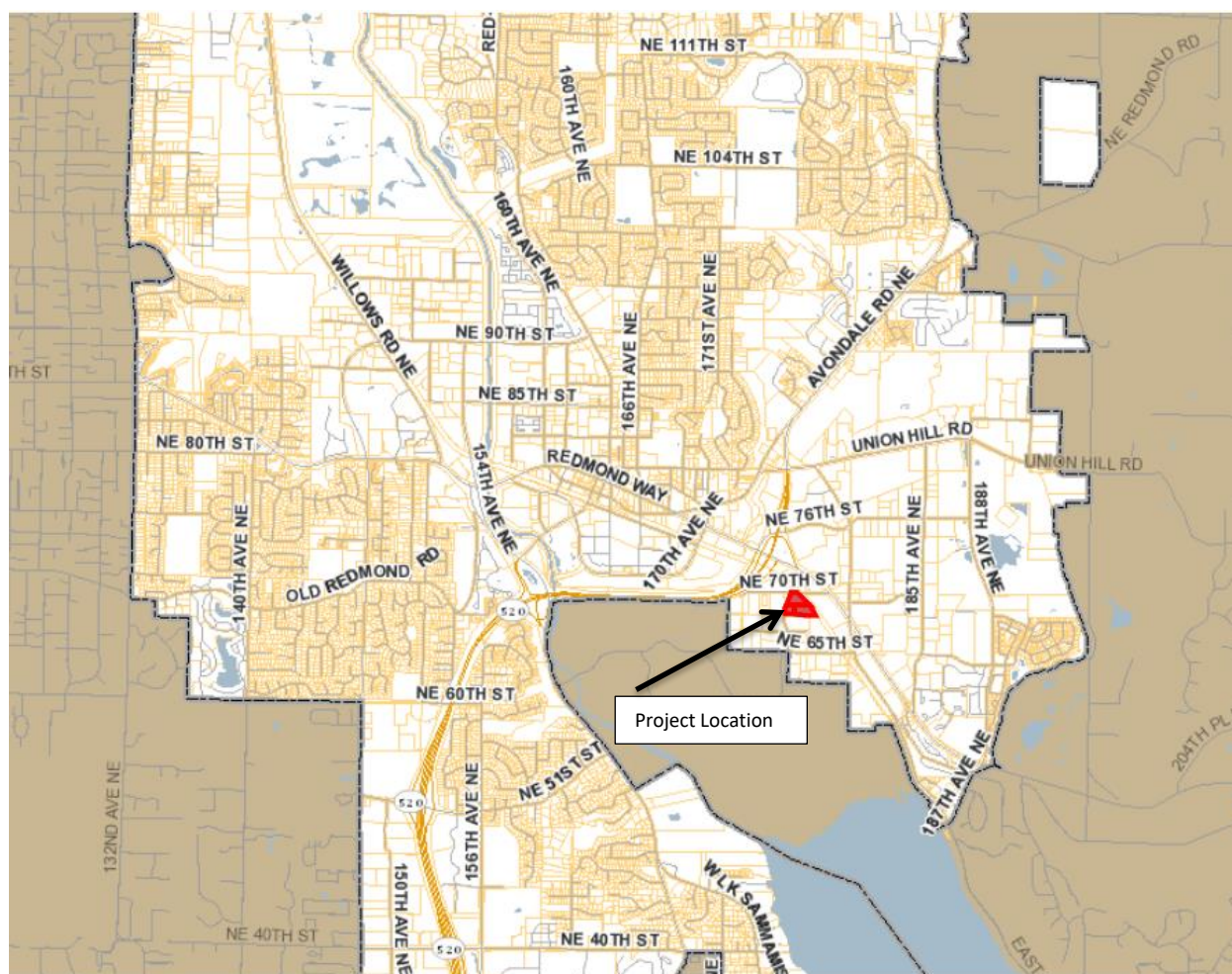
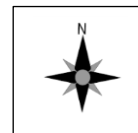

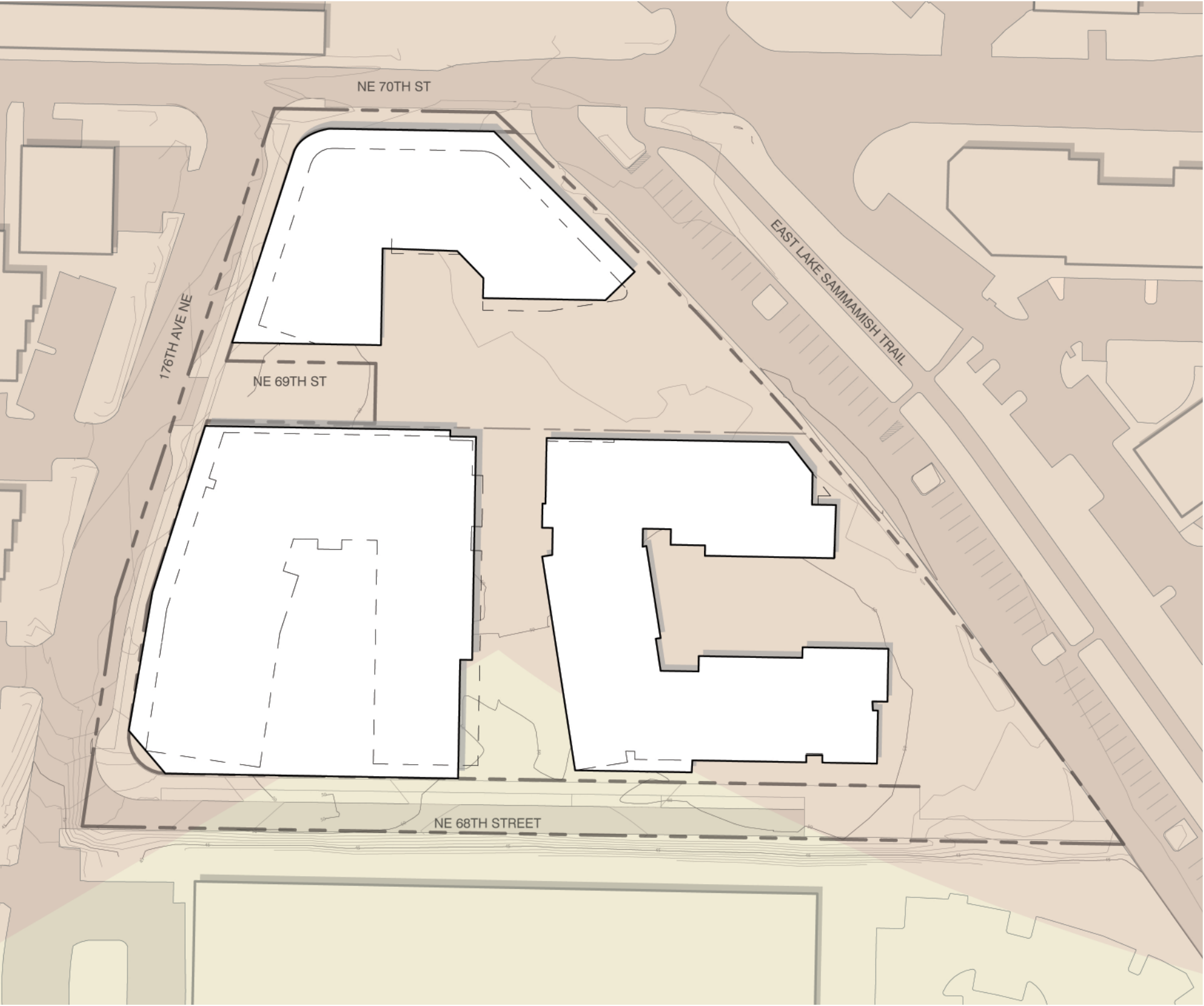

CRITICAL AREA BOUNDARIES

The property is within two wellhead protection zones, Zone 3 and Zone 4. The zones are based on the time it takes a drop of water to travel from the point where it enters the aquifer to the point where it enters the cloests drinking water well. In Zone 3 it takes up to 10 years to travel to the nearest drinking water well.

WELLHEAD PROTECTION ZONE LEGEND

- ZONE 3
- ZONE 4



Process Flow Chart for: Type V

Master Planned Development & Development Agreement Applications

Long Term Temporary Use Applications follow the Type V Process. A public hearing before the City Council is required. The City Council is the final decision maker.

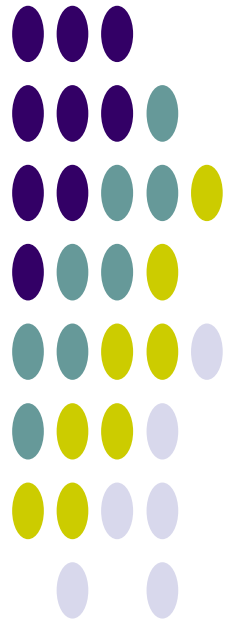

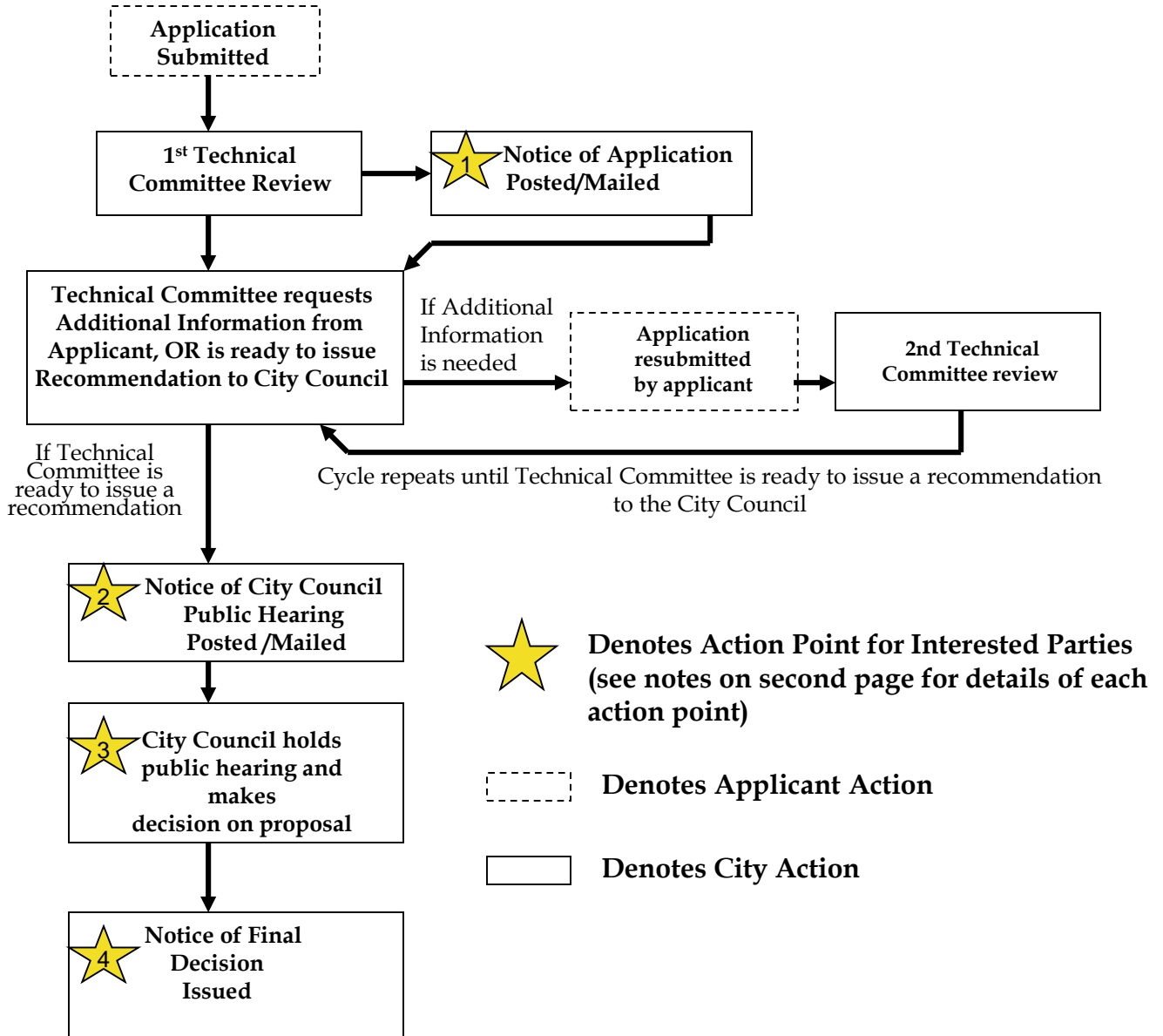

Notes on Participation Points 1-4

#1- Notice of Application (completed within 14 days of application):

Sent to: Applicant, property owners and residents within 500 feet

Posted: On site, City Hall, Library, Internet.

Who May Participate? Any interested party may submit comments prior to or at hearing to establish themselves as Party of Record. Although comments are accepted up until close of public hearing, submittal of comments during the 21 day comment period is encouraged to allow staff and/or the applicant to incorporate changes as early in the design process as possible.

#2-Notice of Public Hearing (sent 21 days in advance of hearing):

Sent to: Applicant and Parties of Record

Posted: On site, City Hall, Library, internet, published in paper

Who May Participate? Any person may participate by submitting written comments prior to the hearing or by submitting written or oral comments at the hearing.

#3-City Council Public Hearing:

Who May Participate? Any person may participate and establish themselves as a Party of Record by submitting written comments prior to hearing, submitting written comments at hearing or making oral comments at hearing.

#4-Notice of Final Decision (typically sent within 14 days after City Council decision):

Sent to: Applicant and Parties of Record

Appeal Provision: The decision of the City Council is appealable to King County Superior Court within 21 days from issuance of Notice. To have standing to appeal, one must meet the criteria under the Land Use Petition Act (L.U.P.A.).

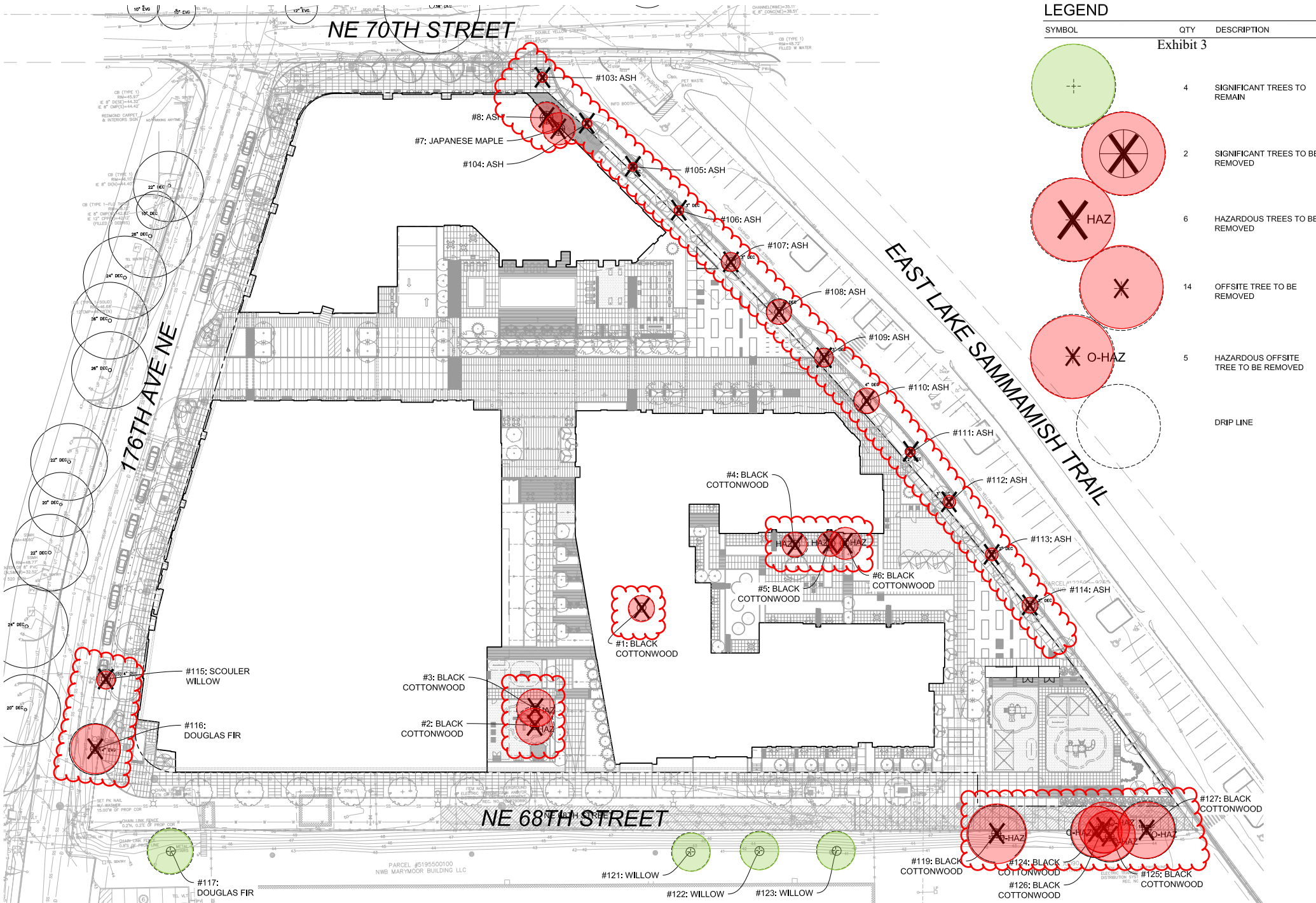

ONE MARYMOOR PARK

PUBLIC NOTICE - TREE PRESERVATION PLAN

